



# INSTRUCTION BULLETIN

No. 9014047  
Machine: T17 (Europe)  
Published: 12-2019  
Rev. 00

**NOTE: DO NOT DISCARD the Parts List from the Instruction Bulletin. Place the Parts List in the appropriate place in the machine manual for future reference. Retaining the Parts List will make it easier to reorder individual parts and will save the cost of ordering an entire kit.**

*NOTE: Numbers in parenthesis ( ) are reference numbers for parts listed in Bill of Materials.*

Installation instructions for **kit number 9014023**

Kit installation must be performed by TennantTrue<sup>®</sup> service or an authorized service provider.

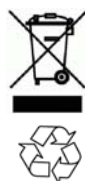
## SYNOPSIS:

This kit contains the parts needed to install the telemetry kit onto T17 scrubbers.  
Please follow step-by-step instructions.

## SPECIAL TOOLS / CONSIDERATIONS: NONE

(Estimated time to complete: 2 - 3 hours)

**The IRIS (telemetry module) must be activated to complete this installation. Module will not function until it is activated. Call local IRIS expert for assistance activating module after all telemetry components have been installed. Have machine serial number and IRIS module SIM number (located on back of IRIS control box assembly) ready when calling for activation.**



## PROTECT THE ENVIRONMENT

Please dispose of packaging materials, used machine components such as batteries and fluids in an environmentally safe way according to local waste disposal regulations.

Always remember to recycle.

## PREPARATION:

1. Confirm the hour meter is properly wired and functional. The hour meter must be fully functional and properly wired before the IRIS system can be installed.
2. Stop the machine on a level surface and turn off the machine.
3. Remove the brushes from the main scrub head. Set the brushes aside.
4. **Machines equipped with cylindrical brushes only:** Remove the debris trough from the back of the scrub head.
5. Turn on the machine, completely lower the scrub head, turn off the machine, set the parking brake, and remove the key.

**FOR SAFETY: Before leaving or servicing machine, stop on level surface, turn off machine, set parking brake, and remove key.**

6. Evaluate the condition of batteries, cables, and terminal connections. Batteries /cables/ terminal connections must all be in safe working condition.
7. Disconnect the battery cable from the machine.



**WARNING: Always disconnect battery cables from machine before working on electrical components.**

8. Remove the battery from the machine.

**FOR SAFETY: When servicing machine, use a non-conductive battery removal device, use a hoist and adequate assistance when lifting batteries, battery installation must be done by trained personnel, follow site safety guidelines concerning battery removal.**

9. Remove the SEMS M6 hex screws securing the electrical enclosure cover to the electrical enclosure. Set the SEMS M6 hex screws aside. (Fig. 1)



FIG. 1

10. Carefully remove the electrical enclosure cover from the electrical enclosure and position as shown. **Do Not** break or damage wires/wire connections when removing the electrical enclosure cover from the electrical enclosure. (Fig. 1/Fig. 2)

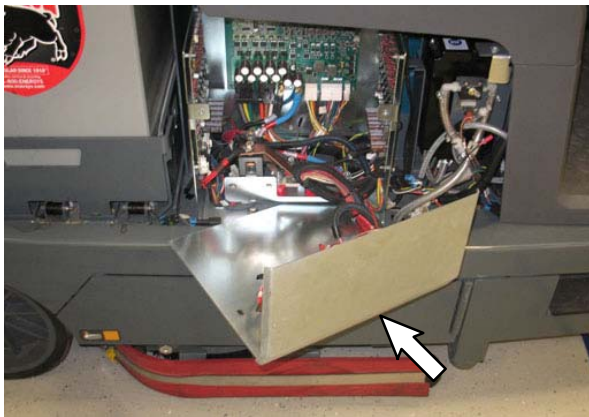


FIG. 2

11. Disconnect the existing battery cable from the B+ at M1 location on the 36 VDC contactor and the insulated rubber standoff (machine negative) inside the electrical enclosure. Set all hardware used to secure the battery cable to B+ at M1 and machine ground aside. Discard the removed battery cable. (Fig. 3)

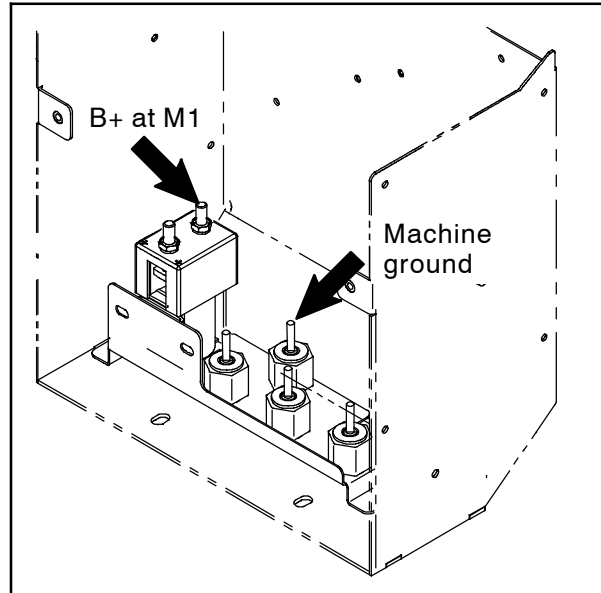


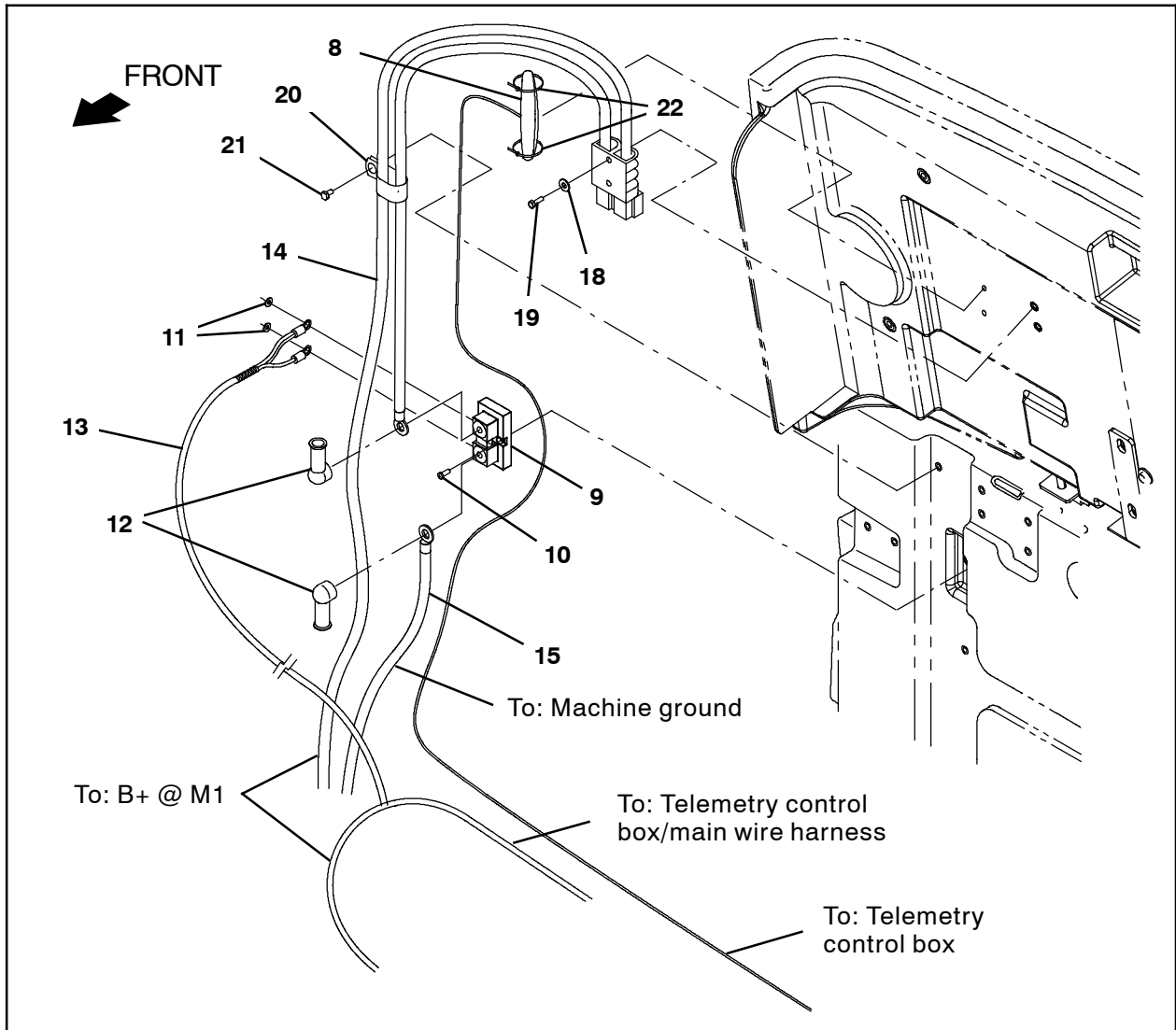
FIG. 3

#### INSTALLATION:

1. Use two M4 pan screws (10) to install the shunt (9) onto the recovery tank. (Fig. 4)
2. Use two hex screws (19) and two flat washers (18) to install the new battery cable (14) onto the battery cover. (Fig. 4/Fig. 5)



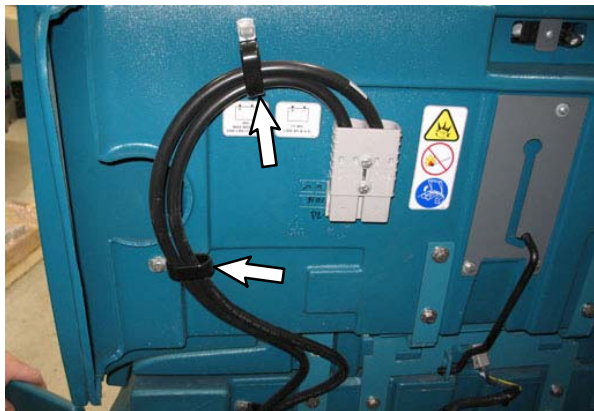
FIG. 4



**FIG. 5**

3. Use the M8 hex screws (21) and three cable clamps (20) to secure the battery cable (14) to the battery cover. (Fig. 6)

4. Route the battery cable (14) to the shunt (9). (Fig. 7)

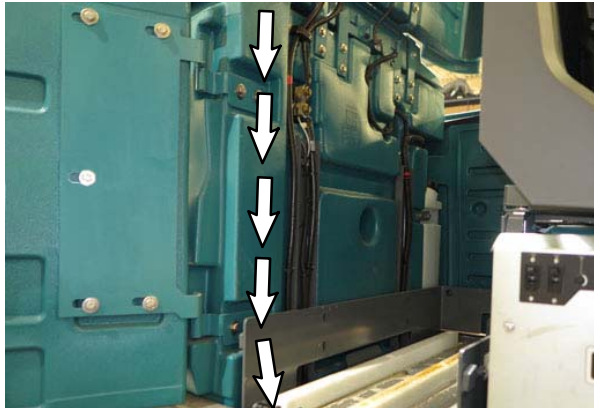


**FIG. 6**

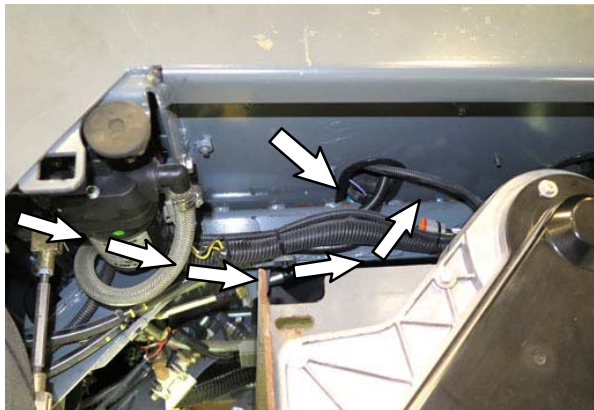


**FIG. 7**

5. Slide a terminal boot (12) onto the battery cable (14) black cable and connect the black cable to the shunt (9). (Fig. 5)
6. Slide a terminal boot (12) onto the black cable (15) and connect the black cable to the shunt (9). (Fig. 5)
7. Route the battery cable (14) red cable and the black cable (15) down toward the floor and then up along the frame of the machine to the hole in the electrical compartment. (Fig. 8/ Fig. 9)

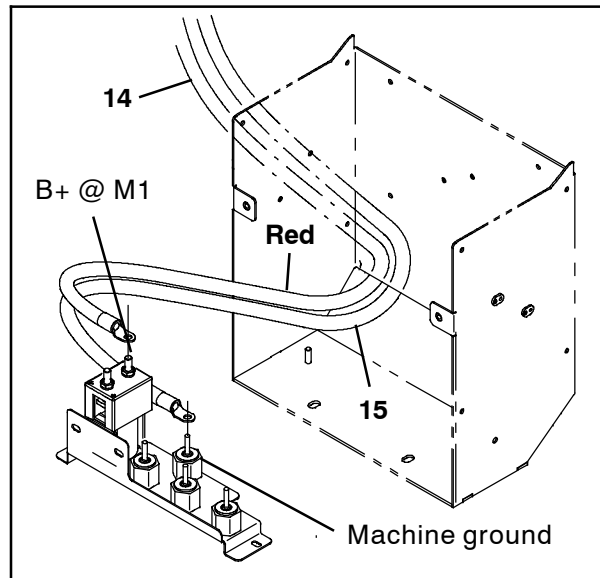


**FIG. 8**



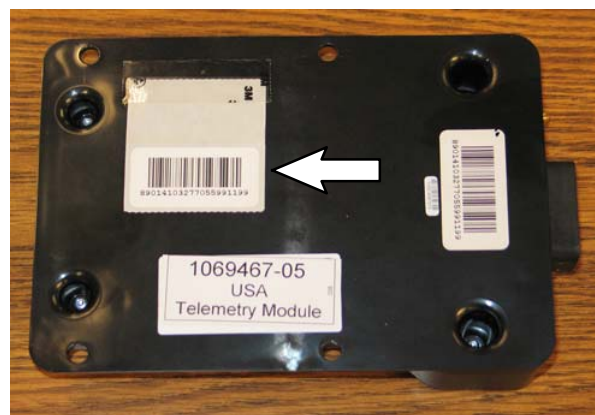
**FIG. 9**

8. Connect the other end of the black cable (15) connected to the shunt (9) to the insulated rubber standoff (machine negative) inside the electrical enclosure. (Fig. 10/Fig. 5)



**FIG. 10**

9. Route the battery cable (14) red cable into the electrical enclosure and connect the red cable to the B+ at M1 location on the 36 VDC contactor. (Fig. 10/Fig. 5)
10. Remove the additional SIM label from the back of the control box (1) and set label aside in a safe place. The number on the SIM label will be needed for activating the machine. (Fig. 11)



**FIG. 11**

11. Insert a cable tie clip (16) into the frame of the machine. (Fig. 12)
12. Use four M5 hex screws (3), four flat washers (4), and four M5 hex lock nuts (5) to install the telemetry control box (1) onto the telemetry bracket (2). (Fig. 12)
13. Use two M6 hex lock nuts (7) and two flat washers (6) to install the control box (1)/telemetry bracket (2) onto the frame of the machine. (Fig. 12)
14. Connect the telemetry harness (13) to the main wire harness. (Fig. 12/Fig. 19)
15. Use a cable tie (17) to secure the telemetry harness (13) to the cable tie clip (16) previously inserted into the frame of the machine. (Fig. 12)

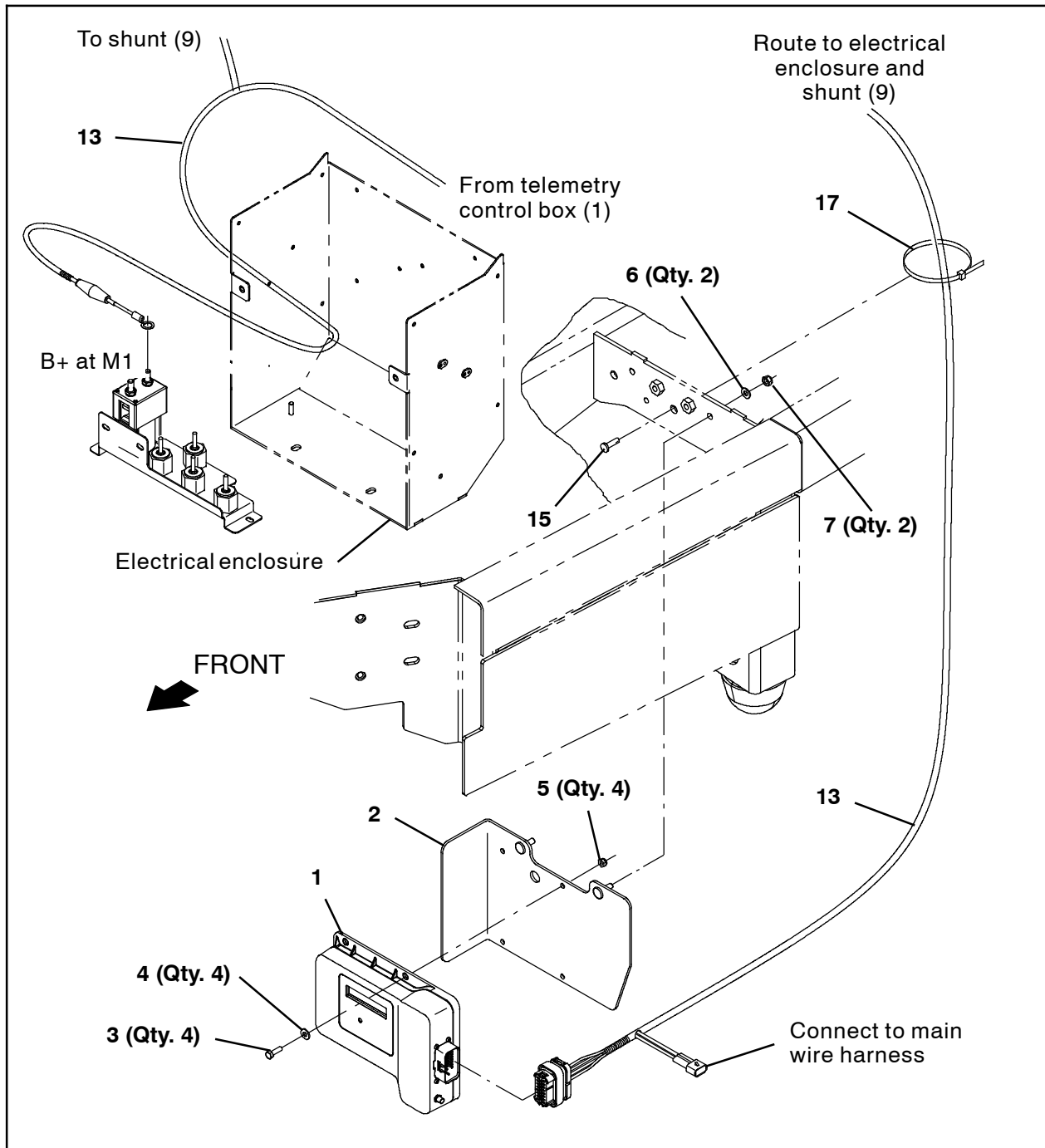
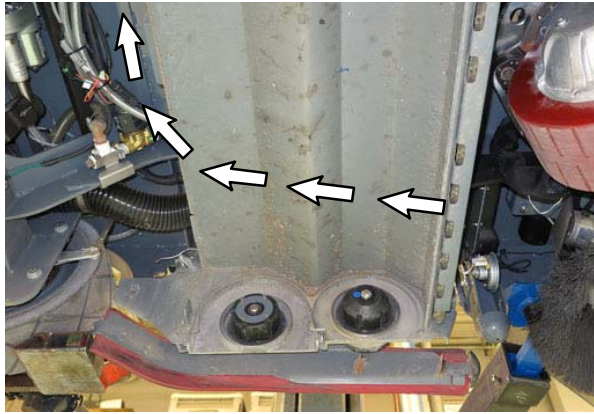


FIG. 12

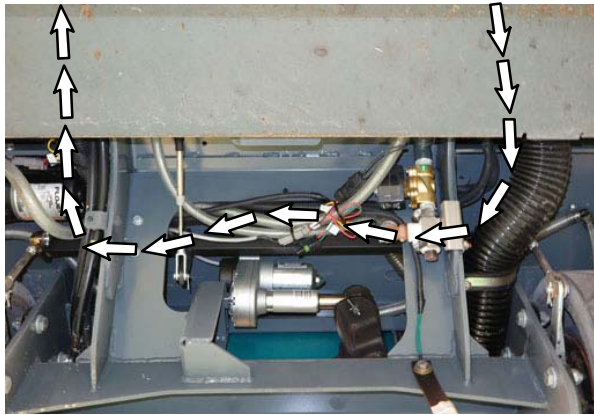


*INSTALLATION TIP: Secure a thin gauge wire, approximately the length of the telemetry harness (13), to the end of the telemetry harness to be connected to the shunt (9) and route the wire with the telemetry harness. This wire can then be secured to the antenna (8) wire to help route the antenna wire along the telemetry harness to the telemetry control box (1).*

16. Route the telemetry harness (13) along the main wire harness/frame cross member, over the top of the scrub head, through the channel behind the scrub head, along the opposite frame cross member to the opening in the electrical enclosure. (Fig. 13/Fig. 14)

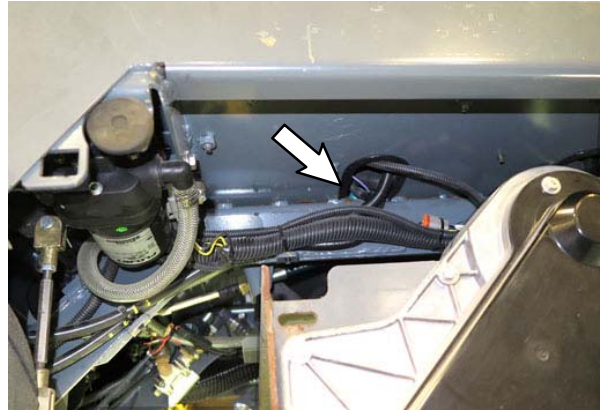


**FIG. 13**



**FIG. 14**

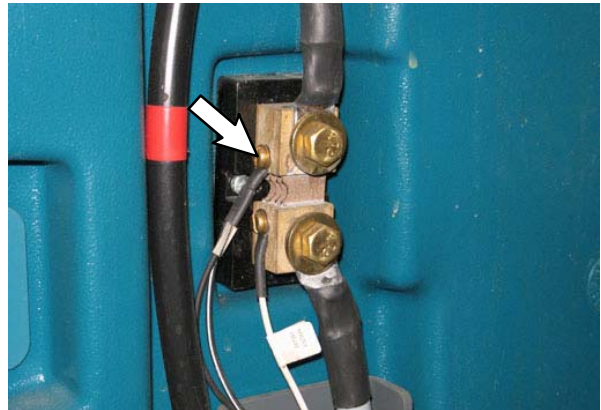
17. Route the telemetry harness (13) lead to be connected to the B+ at M1 location on the 36 VDC contactor up into the electrical enclosure and attach the lead to the 36 VDC contactor. (Fig. 15/Fig. 12/Fig. 18)



**FIG. 15**

18. Route telemetry harness (13) 13/BLK-WHT and 79/WHT leads along the battery cable (14) and up to the shunt (9).

19. Connect the telemetry harness (13) 13/BLK-WHT wire to the shunt (9). (Fig. 16/Fig. 18)



**FIG. 16**

20. Connect the telemetry harness (13) 79/WHT wire to the shunt (9). (Fig. 17/Fig. 18)



**FIG. 17**

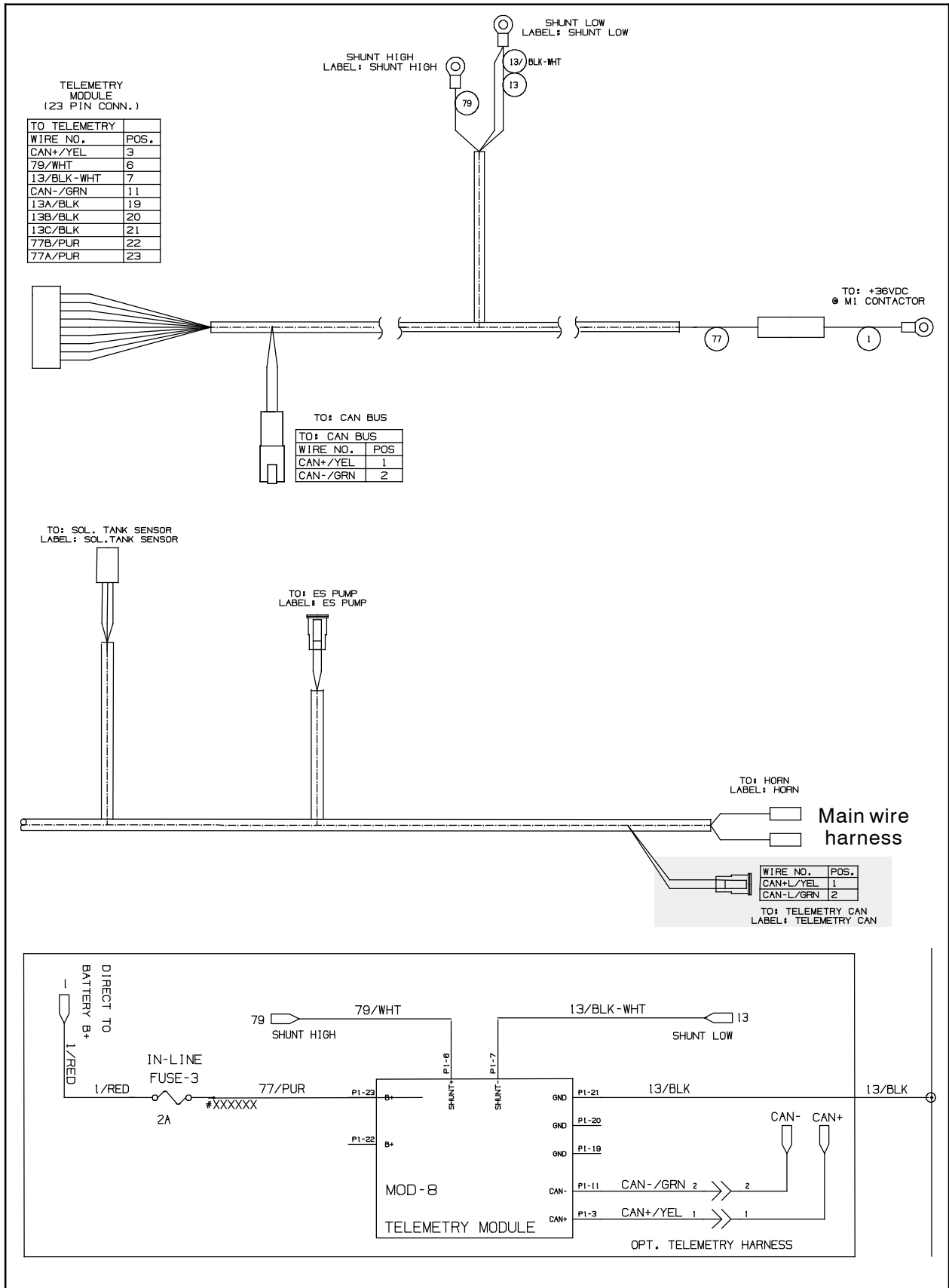
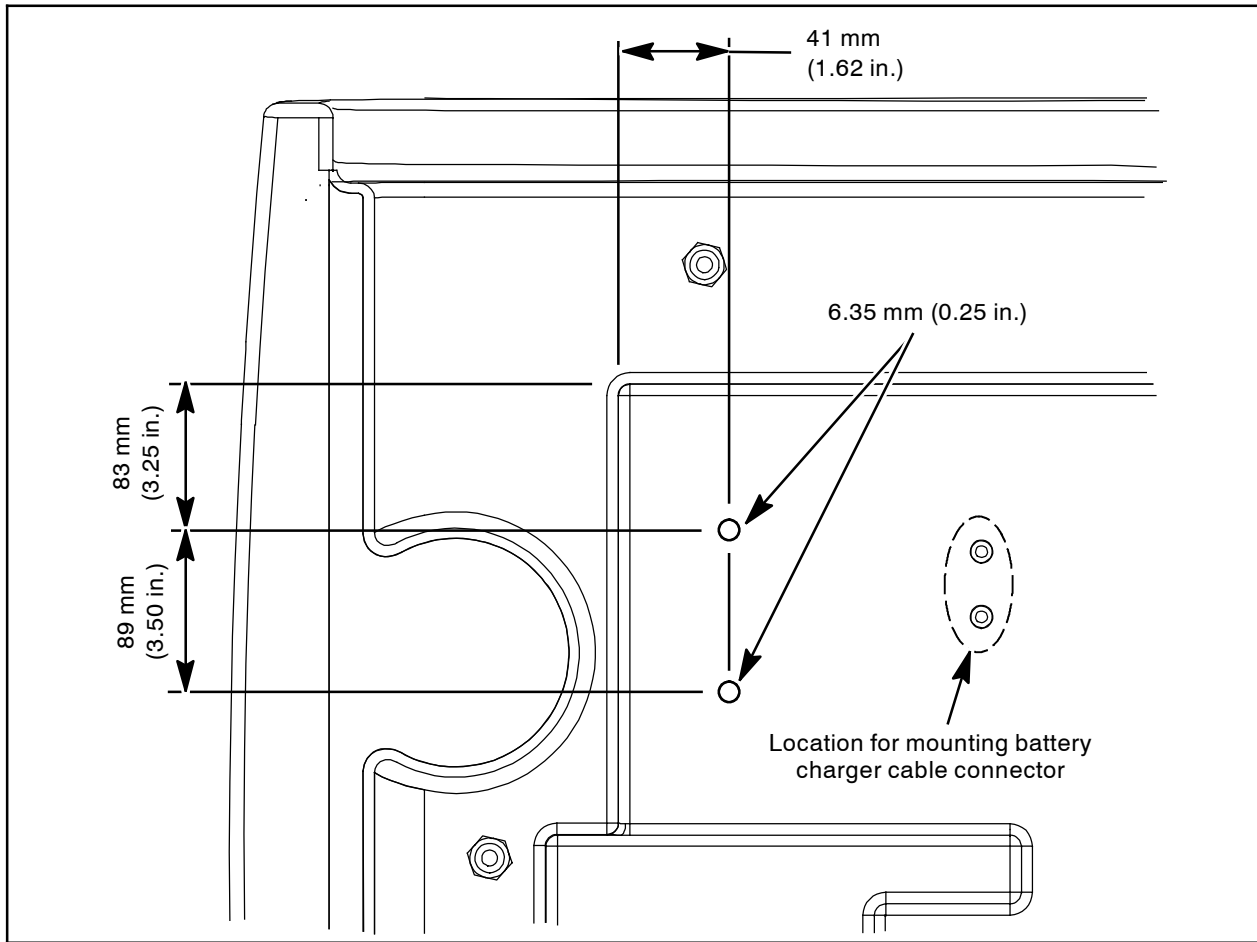


FIG. 18

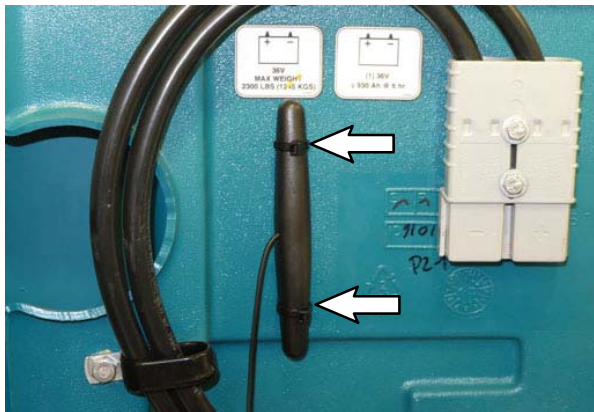


**FIG. 19**

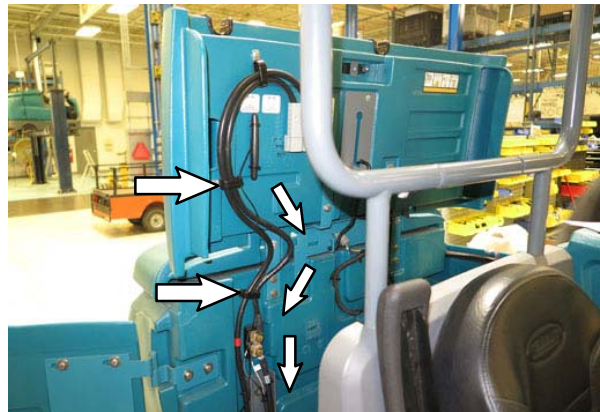
21. Drill two 6.35 mm (0.25 in.) holes into battery compartment cover. **Do Not** drill up into the top surface of the battery compartment cover. (Fig. 19)

22. Install two cable tie clips (16)/cable ties (17) into the 6.35 mm (0.25 in.) holes and use the cable tie clips/cable ties to secure the antenna (8) to the battery compartment cover. (Fig. 20)

23. Route the antenna (8) wire through the cable clamps (20), along the main battery cable (14) /telemetry harness (13), and to the telemetry control box (1). (Fig. 21)



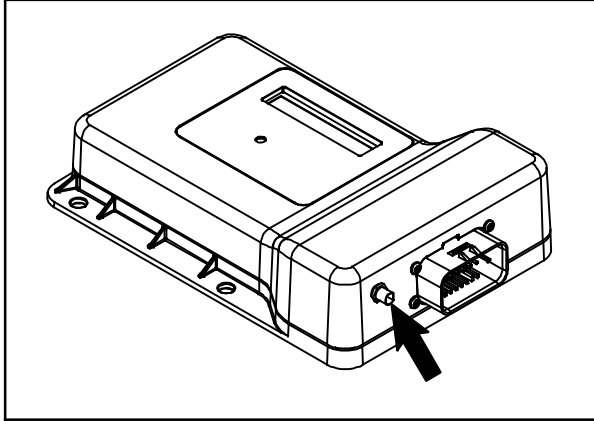
**FIG. 20**



**FIG. 21**



24. Connect the antenna (8) wire to the telemetry control box (1). (Fig. 22)



**FIG. 22**

25. Use cable ties (17) to secure the telemetry harness (13) and antenna (8) wire away from moving parts or areas where they can be damaged.
26. Reinstall the electrical enclosure cover onto the electrical enclosure.
27. Reinstall the battery into the battery compartment and connect the battery cable to the machine.

28. Start the machine, raise the scrub head, and turn off the machine.
29. Reinstall the brushes into the main scrub head.
30. **Machines equipped with cylindrical brushes only:** Reinstall the debris trough onto the scrub head.
31. Start and test the machine.
32. Activate the IRIS (telemetry module): Call local IRIS expert for assistance to activate the module. The IRIS telemetry system must be activated to complete installation.

*NOTE: The IRIS (telemetry module) must be activated to complete installation. The module will not function until it is activated. Call local IRIS expert for assistance activating the module after all telemetry components have been installed.*

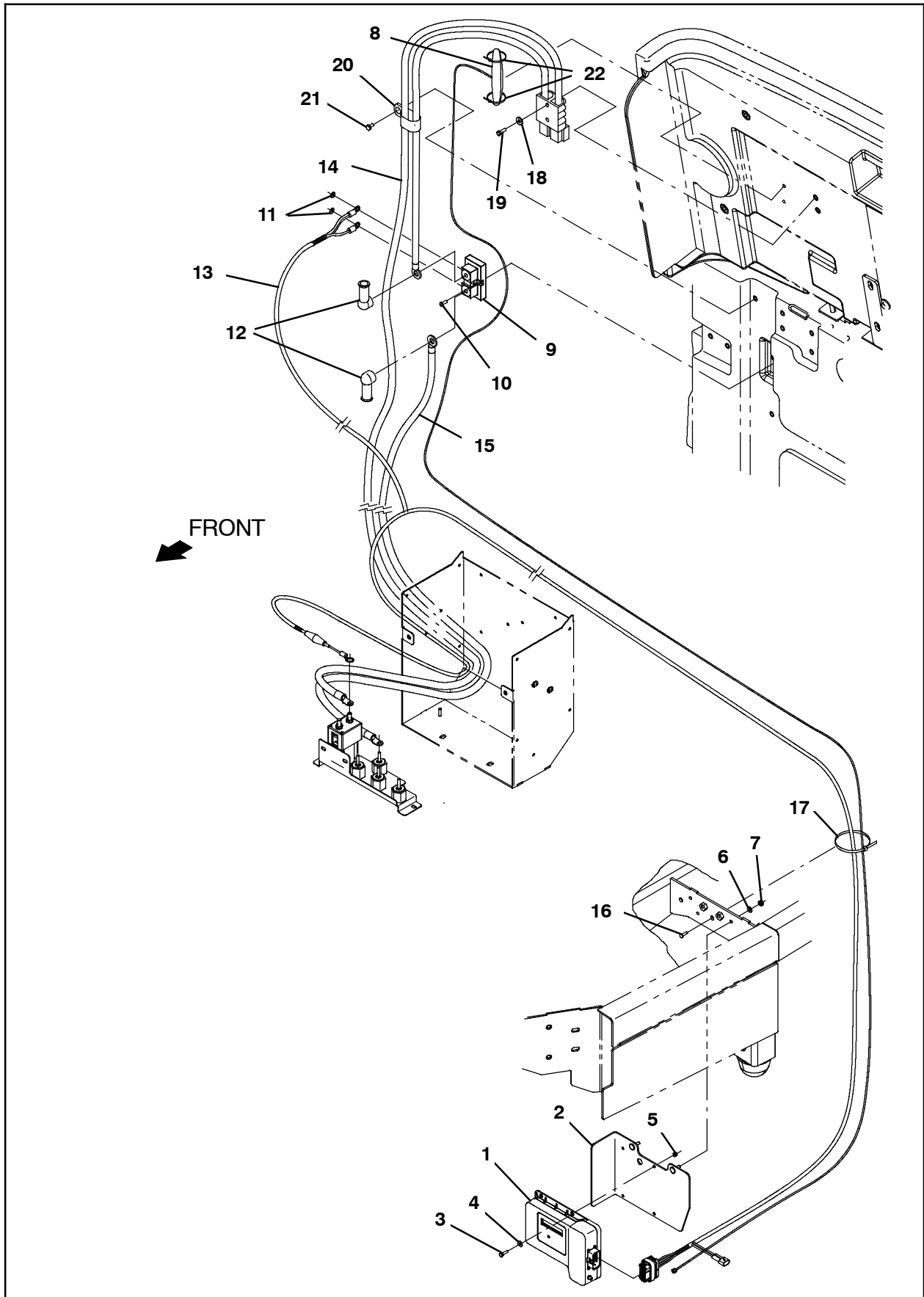


FIG. 23

**Bill Of Materials For Telemetry Kit, CI [T17, Intl/EU] - 9014023**

<b>Ref.</b>	<b>Tennant Part No.</b>	<b>Description</b>	<b>Qty.</b>	
1	1070541	Controlbox Assy, Telem [Int]	1	
2	1207701	Bracket Wldt, Mtg, Telem	1	
3	24199	Screw, Hex, M5 X 0.80 X 16, SS	6	
4	01683	Washer, Flat, 10, SS	10	
5	06549	Nut, Hex, Lock, M5 X 0.80, NI	6	
6	01684	Washer, Flat, 0.27b 0.69d .05, SS	2	
7	08712	Nut, Hex, Lock, M6 X 1.00, NI, SS	2	
8	1070658	Antenna, Telem, 187 In [GPRS]	1	
9	1070757	Shunt, 050mv 400a	1	
10	06927	Screw, Pan, Phl, M4 X 0.70 X 16, 4.8	2	
11	07514	Washer, Lock, Int, 10, SS	2	
12	611221	Boot, Terminal, Battery, 25.4mm, Blk	2	
▽	13	1073059	Harness, Ele [Telemetry, T17]	1
▲		9009990	Fuse, 002a, 250vdc, Cartridge	1
14	1074600	Cable, Battery, 2/0ga [M17, Telem]	1	
15	1074601	Cable, 2/0ga 61.0l Blk [M6 Ring/M9 Ring]	1	
16	1071085	Clip, Tie, 0.25d, Plstc	1	
17	130773	Tie, Cable, Nyl, 11.0l, .14w, 3.0 Max. D	12	
18	32483	Washer, Flat, 0.25, SAE	2	
19	33930	Screw, Hex, M6 X 1.00 X 40, SS	2	
20	69234	Clamp, Cable, Stl, 1.00d X 0.75w, 1hole	2	
21	09740	Screw, Hex, M8 X 1.25 X 20, SS	3	
22	1210807	Wire, Tie [W/.25" Fir Tree Clip]	2	

TENNANT COMPANY  
P. O. Box 1452  
Minneapolis, MN 55440-1452